

TABERNACLE/TEMPLE SIZE COMPARISON

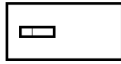

THE TABERNACLE

- Described in Exodus 25-30, 40
- ~1444-963 BC
- 150 feet wide
- Traveling tent of worship while the Israelites traveled the wilderness to Canaan
- Used from the time of Moses to King Solomon

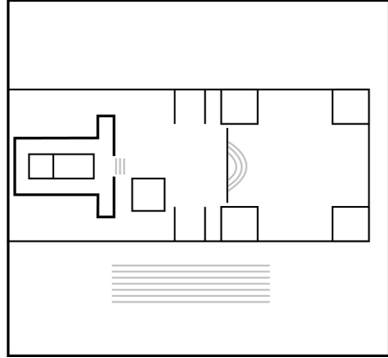

SOLOMON'S TEMPLE

- Described in 1 Kings 6, 8
- ~963-586 BC
- 500 feet wide
- Permanent place of worship
- Ransacked & destroyed by Babylonians in 586 BC
- Partially rebuilt by Zerubbabel 536-516 BC

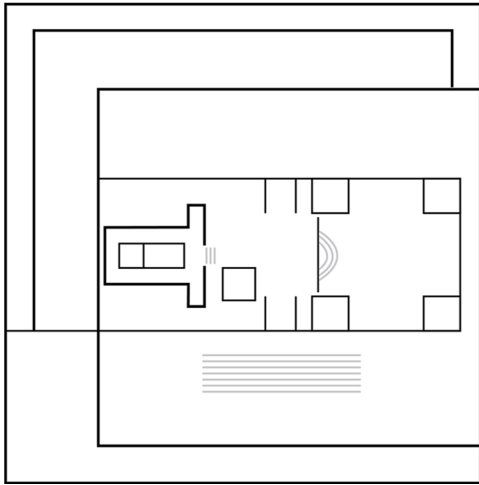

HEROD'S TEMPLE

- Construction began during the Intertestamental Period and continued into the 1st C., ~20 BC-70 AD
- 600 feet wide
- Herod the Great expanded the Temple to appease the Jewish people
- This would have been the Temple Jesus saw
- Destroyed in 70 AD by the Roman Empire when the Jewish people rebelled

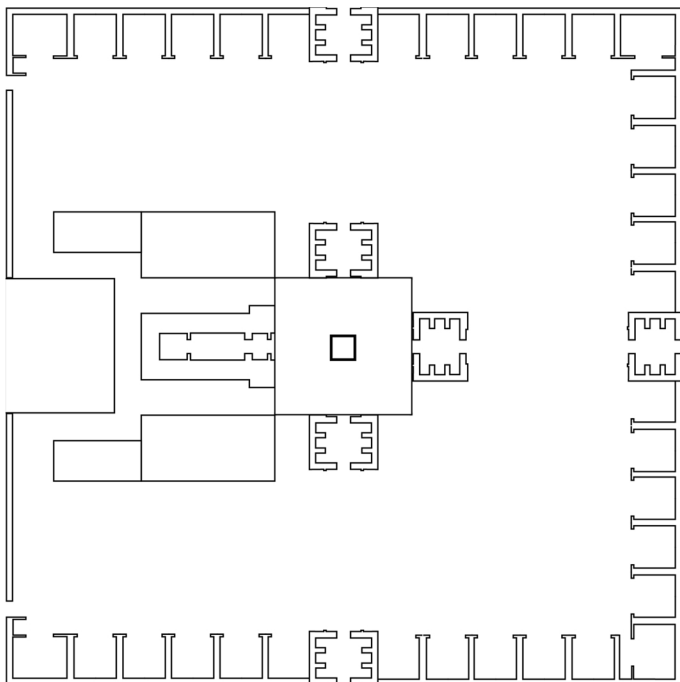

EZEKIEL'S MILLENNIAL TEMPLE

- Described in Ezekiel 40-43
- 875 feet wide
- Based upon a vision the prophet Ezekiel received while he was in Babylon
- Some scholars believe the vision is of a Temple during Christ's Millennial reign